



**TANNER**

MAQUINAS Y HERRAMIENTAS

# SECO ROUND 10 & 16 COPY MILLING INSERTS

## PRODUCT SUMMARY & RANGE

**SECO** 

# FOR LONG TOOL LIFE AND PROCESS STABILITY ROUND COPY MILLING INSERTS

You lose tool life and process security when inserts rotate in cutter body pockets during milling operations. Keep inserts locked in place, especially in heavy or rough machining operations, with our Round 10 and 16 milling inserts.

This product line of secure inserts makes it fast and easy for all operators to use. The round 10 and 16mm inserts incorporate notches that align with those in the cutter body pocket for more efficient machining.

Eliminate unused edges with our anti-rotation feature that provides exact indexing and ensures all insert edges are used. Depending on desired depths-of-cut, the inserts index either four or eight edges, while others in the series provide three or six edges.

Seco's complete range of round milling inserts are well-suited for all your milling needs and applications, even in the most demanding conditions.

### KEY BENEFITS

- Process security thanks to indexed inserts
- Cost effectiveness due to optimized design
- Stability due to anti-rotation feature

Ensure fast, easy, and precise indexing with optimized geometries.

### RANGE OVERVIEW

#### Round 10

- 20 mm – 63 mm (1" - 2")
- 35 insert types
- Combimaster™, arbor, Weldon, and cylindrical shank style connection types

#### Round 16

- 32 mm – 160 mm (2" - 4")
- 32 insert types
- Combimaster and arbor style connection types

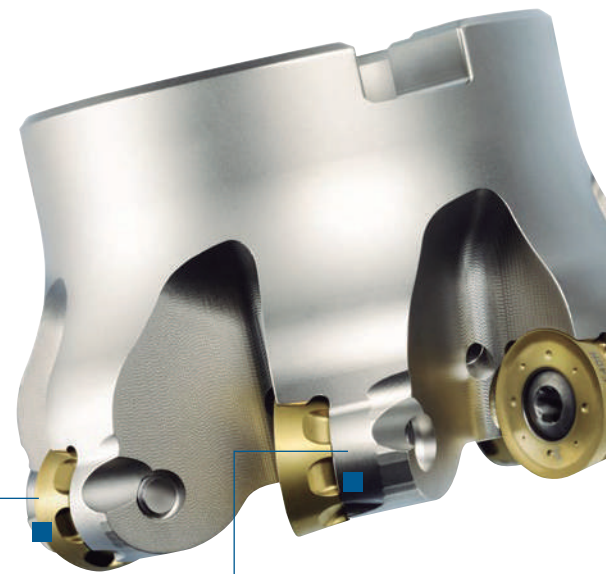

Extend tool life and increase process security with the anti-rotation feature.

#### Contact us:

##### CHIHUAHUA. CHIH

gerencianoroeste@tannerherramientas.com  
Tel: (614) 414 2223

##### GUAYMAS. SON

gerencianoroeste@tannerherramientas.com  
Tel: (622) 224 6081

##### QUERÉTARO. QRO

gerenciacentro@tannerherramientas.com  
Tel: (442) 216 8862

#### Follow us on:



##### EL PASO. TX

texas@tannerherramientas.com  
Tel: (915) 532 6165

##### MONTERREY. NL

gerencianoroeste@tannerherramientas.com  
Tel: (81) 8312 1711

##### TORREÓN. COAH

gerenciacoah@tannerherramientas.com  
Tel: (871) 169 3540

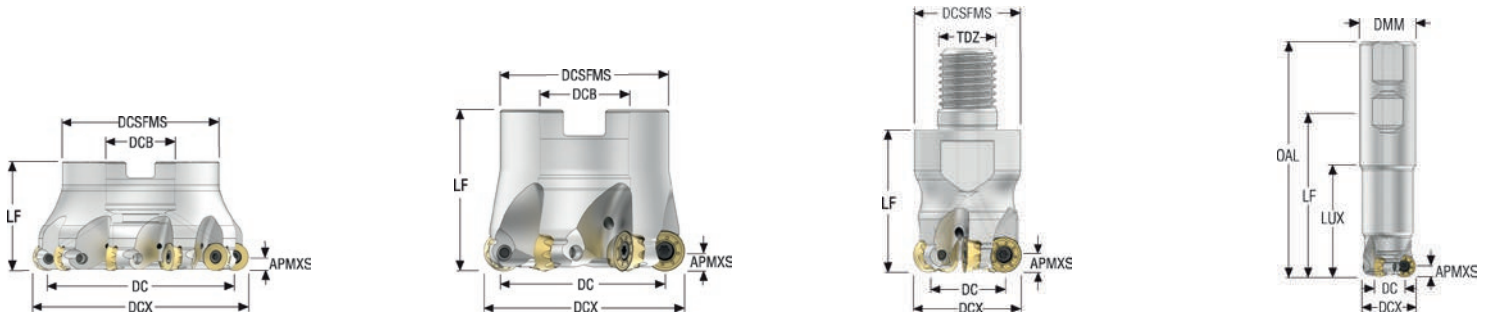

## R217.29I/R217.29I - ROUND 10 INSERTS - METRIC

PRODUCT NUMBER	DESIGNATION	TYPE OF MOUNTING	DIMENSIONS IN MM											RMPX°	C MIN	C MAX		KG		INSERT
			APMXS	DCX	DC	DMM	OAL	LUX	LPR	LF	DC	DCX	DCB							
<a href="#">03278796</a>	R217.29I-2016.0-05.1.100A	Cylindrical	5,0	16,0	5,9	20,0	150,0	60,0	100,0	-	6,9	21,8	30	1	0,3	29900	RD..10T3..			
<a href="#">03278795</a>	R217.29I-1620.0-05.2.112E	Cylindrical	5,0	20,0	10,0	16,0	160,0	112,0	112,0	-	90,0	30,0	38	2	0,5	27400	RD..10T3..			
<a href="#">03278800</a>	R217.29I-2520.3-05.2.070A	Weldon	5,0	20,0	10,0	25,0	125,5	70,0	70,0	94,0	90,0	30,0	38	2	0,4	27400	RD..10T3..			
<a href="#">03278797</a>	R217.29I-2025.0-05.2.120A	Cylindrical	5,0	25,0	15,0	20,0	170,0	120,0	120,0	-	14,5	40,0	48	2	0,4	24400	RD..10T3..			
<a href="#">03278801</a>	R217.29I-2525.3-05.3.050A	Weldon	5,0	25,0	15,0	25,0	105,5	50,0	50,0	74,0	14,4	40,0	48	3	0,4	24400	RD..10T3..			
<a href="#">03278798</a>	R217.29I-2525.0-05.3.124A	Cylindrical	5,0	25,0	15,0	25,0	180,0	124,0	124,0	-	13,8	40,0	48	3	0,7	24400	RD..10T3..			
<a href="#">03278799</a>	R217.29I-2527.0-05.3.124A	Cylindrical	5,0	27,0	17,0	25,0	180,0	124,0	124,0	-	11,6	44,4	52	3	0,7	24400	RD..10T3..			
<a href="#">03278802</a>	R217.29I-3232.3-05.4.060A	Weldon	5,0	32,0	22,0	32,0	119,5	60,0	60,0	84,0	8,7	54,0	62	4	0,7	21600	RD..10T3..			

## R217.29I/R217.29I - ROUND 10 INSERTS - INCH

PRODUCT NUMBER	DESIGNATION	TYPE OF MOUNTING	DIMENSIONS IN INCH											RMPX°		KG		INSERT
			APMXS	DCX	DC	DCSFMS	DCB	TDZ	LF	DC	DCX	DCB	DCSFMS					
<a href="#">03278809</a>	R217.29I-1.00-12RE-05-3A	Arbor	0.197	1.00	0.61	0.91	-	M12	1.18	13.3	3	0.22	24400	RD..10T3				
<a href="#">03278810</a>	R217.29I-1.25-16RE-05-4A	Arbor	0.197	1.25	0.86	1.18	-	M16	1.57	8.90	4	0.44	21600	RD..10T3				
<a href="#">03278811</a>	R217.29I-1.50-16RE-05-5A	Arbor	0.197	1.50	1.11	1.18	-	M16	1.57	6.00	5	0.66	19300	RD..10T3				
<a href="#">03278813</a>	R220.29I-01.50-05-5A	Arbor	0.197	1.50	1.11	1.34	0.50	-	1.50	6.50	5	0.44	14000	RD..10T3				
<a href="#">03278814</a>	R220.29I-02.00-05-6A	Arbor	0.197	2.00	1.61	1.61	0.75	-	1.50	4.20	6	0.66	12500	RD..10T3				

## R217.29I/R217.29I - ROUND 16 INSERTS - METRIC

PRODUCT NUMBER	DESIGNATION	TYPE OF MOUNTING	DIMENSIONS IN MM							RMPX°	C MIN	C MAX				INSERT
			APMXS	DCX	DC	DCSFMS	DCB	TDZ	LF							
<a href="#">03278781</a>	R217.29I-1020.RE-05.2A	Combimaster	5,0	20,0	10,0	18,5	–	M10	28,0	90,0	30,0	38,0	2	0,1	27400	RD..10T3..
<a href="#">03278782</a>	R217.29I-1225.RE-05.3A	Combimaster	5,0	25,0	15,0	23,0	–	M12	30,0	13,8	40,0	48,0	3	0,1	24400	RD..10T3..
<a href="#">03278783</a>	R217.29I-1232.RE-05.4A	Combimaster	5,0	32,0	22,0	23,0	–	M12	30,0	8,0	54,0	62,0	4	0,1	21600	RD..10T3..
<a href="#">03278784</a>	R217.29I-1632.RE-05.4A	Combimaster	5,0	32,0	22,0	30,0	–	M16	40,0	8,8	54,0	62,0	4	0,2	21600	RD..10T3..
<a href="#">03278785</a>	R217.29I-1632.RE-05.5A	Combimaster	5,0	32,0	22,2	30,0	–	M16	40,0	4,1	54,4	62,0	5	0,2	21600	RD..10T3..
<a href="#">03278786</a>	R217.29I-1635.RE-05.5A	Combimaster	5,0	35,0	25,1	30,0	–	M16	40,0	7,5	60,2	68,0	5	0,2	15600	RD..10T3..
<a href="#">03278787</a>	R217.29I-1640.RE-05.4A	Combimaster	5,0	40,0	30,0	30,0	–	M16	40,0	5,5	70,0	78,0	4	0,3	19300	RD..10T3..
<a href="#">03278788</a>	R217.29I-1640.RE-05.5A	Combimaster	5,0	40,0	30,0	30,0	–	M16	40,0	5,5	70,0	78,0	5	0,3	19300	RD..10T3..
<a href="#">03278789</a>	R217.29I-1642.RE-05.5A	Combimaster	5,0	42,0	32,0	30,0	–	M16	40,0	5,6	74,0	82,0	5	0,3	18800	RD..10T3..
<a href="#">03278791</a>	R217.29I-2040.RE-05.6A	Combimaster	5,0	40,0	30,2	36,5	–	M20	40,0	5,9	70,4	78,0	6	0,3	19300	RD..10T3..
<a href="#">03278790</a>	R217.29I-1642.RE-05.6A	Combimaster	5,0	42,0	32,0	30,0	–	M16	40,0	6,0	74,0	82,0	6	0,3	18800	RD..10T3..
<a href="#">03278792</a>	R217.29I-2042.RE-05.6A	Combimaster	5,0	42,0	32,2	36,5	–	M20	40,0	5,5	74,4	82,0	6	0,3	18800	RD..10T3..
<a href="#">03278803</a>	R220.29I-0040-05.5A	Arbor	5,0	40,0	30,0	33,0	16,0	–	40,0	7,3	70,0	78,0	5	0,2	19300	RD..10T3..
<a href="#">03278804</a>	R220.29I-0050-05.4A	Arbor	5,0	50,0	40,0	41,0	22,0	–	40,0	4,3	90,0	98,0	4	0,3	17300	RD..10T3..
<a href="#">03278805</a>	R220.29I-0050-05.6A	Arbor	5,0	50,0	40,0	41,0	22,0	–	40,0	4,3	90,0	98,0	6	0,3	17300	RD..10T3..
<a href="#">03278806</a>	R220.29I-0052-05.7A	Arbor	5,0	52,0	42,1	41,0	22,0	–	40,0	4,3	94,2	102,0	7	0,3	17000	RD..10T3..
<a href="#">03278807</a>	R220.29I-0063-05.6A	Arbor	5,0	63,0	53,0	49,0	22,0	–	40,0	3,1	116,0	124,0	6	0,5	15800	RD..10T3..
<a href="#">03278808</a>	R220.29I-0063-05.8A	Arbor	5,0	63,0	53,0	49,0	22,0	–	40,0	3,9	116,0	124,0	8	0,5	15800	RD..10T3..
<a href="#">03278978</a>	R220.29I-0050-08.4A	Arbor	8,0	50,0	34,2	41,0	22,0	–	50,0	4,8	–	–	4	0,4	9700	RP..1605
<a href="#">03278979</a>	R220.29I-0052-08.4A	Arbor	8,0	52,0	36,2	41,0	22,0	–	50,0	5,7	–	–	4	0,4	9600	RP..1605
<a href="#">03278980</a>	R220.29I-0063-08.4A	Arbor	8,0	63,0	47,1	49,0	22,0	–	50,0	7,5	–	–	4	0,6	8700	RP..1605
<a href="#">03278981</a>	R220.29I-0063-08.5A	Arbor	8,0	63,0	47,1	49,0	22,0	–	50,0	7,1	–	–	5	0,6	8700	RP..1605
<a href="#">03278982</a>	R220.29I-0063-08.6A	Arbor	8,0	63,0	47,1	49,0	22,0	–	50,0	7,1	–	–	6	0,6	8700	RP..1605
<a href="#">03278983</a>	R220.29I-0066-08.5A	Arbor	8,0	66,0	50,1	61,0	27,0	–	50,0	6,9	–	–	5	0,7	8400	RP..1605
<a href="#">03278984</a>	R220.29I-0066-08.6A	Arbor	8,0	66,0	50,0	61,0	27,0	–	50,0	6,7	–	–	6	0,7	8400	RP..1605
<a href="#">03278985</a>	R220.29I-0080-08.5A	Arbor	8,0	80,0	64,1	61,0	27,0	–	50,0	5,0	–	–	5	1,0	7700	RP..1605
<a href="#">03278986</a>	R220.29I-0080-08.7A	Arbor	8,0	80,0	64,1	61,0	27,0	–	50,0	5,0	–	–	7	0,9	7700	RP..1605
<a href="#">03278987</a>	R220.29I-0084-08.5A	Arbor	8,0	84,0	68,1	79,0	32,0	–	50,0	4,6	–	–	5	1,2	7500	RP..1605
<a href="#">03278988</a>	R220.29I-0100-08.8A	Arbor	8,0	100,0	84,1	79,0	32,0	–	50,0	3,7	–	–	8	1,6	6800	RP..1605
<a href="#">03278989</a>	R220.29I-0125-08.10A	Arbor	8,0	125,0	109,1	90,0	40,0	–	63,0	2,8	–	–	10	2,9	6100	RP..1605
<a href="#">03278990</a>	R220.29I-8160-08.10A	Arbor	8,0	160,0	144,1	90,0	40,0	–	63,0	2,1	–	–	10	4,1	5400	RP..1605
<a href="#">03278992</a>	R220.29I-0100.08-6MA	Arbor	8.000	100,0	84.10	79,0	32,00	–	50,0	3,8	–	–	6	1.50	6800	RP..1605..
<a href="#">03278991</a>	R220.29I-0125.08-6MA	Arbor	8.000	125,0	109,1	90,0	40,00	–	63,0	2,8	–	–	6	2.80	6100	RP..1605..
<a href="#">03278993</a>	R220.29I-8160.08-7MA	Arbor	8.000	160,0	143.1	90,0	40,00	–	63,0	2,2	–	–	7	4.20	5400	RP..1605..

## R217.29I/R217.29I - ROUND 16 INSERTS - INCH

PRODUCT NUMBER	DESIGNATION	TYPE OF MOUNTING	DIMENSIONS IN INCH							RMPX°				INSERT
			APMXS	DCX	DC	DCSFMS	DCB	LF						
<a href="#">03278994</a>	R220.29I-02.00-08-4A	Arbor	0.315	2.000	1.380	1.61	0.75	2.00	2.7	4	0.88	9600	RP..1605..	
<a href="#">03278995</a>	R220.29I-02.50-08-5A	Arbor	0.315	2.500	1.880	1.81	0.75	2.00	7.0	5	1.32	8700	RP..1605..	
<a href="#">03278996</a>	R220.29I-03.00-08-6A	Arbor	0.315	3.000	2.380	2.40	1.00	2.00	5.3	6	1.98	7700	RP..1605..	
<a href="#">03278997</a>	R220.29I-04.00-08-7A	Arbor	0.315	4.000	3.380	3.50	1.50	2.50	3.6	7	5.07	6800	RP..1605..	

INDEXABLE EDGES	DESIGNATION	INSD	S	CUTTING RAKE	GRADES																	
					MP1501	MP2050	MP2501	MP3000	MH1000	MM4500	MK1500	MK2050	MS2050	MS2500	T25M	T350M	F15M	F25M	F30M	F40M	HX	H15
<b>RD..10 INSERTS</b>																						
6	RDKT10T3MOT-6-M05	10,0	3,97	16,0°			■								■	■					■	
	RDKW10T3MOT-6-MD06	10,0	3,97	0,0°												■					■	
8	RDHT10T3M0-8-E04	10,0	3,97	20,0°																	■	■
	RDKT10T3MOT-8-M05	10,0	3,97	16,0°		■				■				■	■						■	
	RDHT10T3MOT-8-M11	10,0	3,97	16,0°		■									■						■	
	RDKT10T3MOT-8-M07	10,0	3,97	11,0°		■			■		■				■						■	
	RDHW10T3M0-8-MD04	10,0	3,97	0,0°			■														■	
	RDHW10T3MOT-8-MD06	10,0	3,97	0,0°				■														
	RDKW10T3MOT-8-MD06	10,0	3,97	0,0°		■		■							■	■					■	
	<b>RP..16 INSERTS</b>																					
6	RPHT1605MOT-6-ME11	16,0	5,56	21,0°											■						■	
	RPHT1605MOT-6-M12	16,0	5,56	15,0°																	■	
	RPKT1605MOT-6-M18	16,0	5,56	15,0°			■									■						
	RPKW1605MOT-6-MD20	16,0	5,56	0,0°		■	■							■	■							
8	RPHT1605MOT-8-ME11	16,0	5,56	21,0°		■				■				■	■						■	
	RPHT1605MOT-8-M12	16,0	5,56	15,0°		■				■											■	
	RPKT1605MOT-8-M18	16,0	5,56	15,0°		■		■	■					■	■						■	
	RPKW1605MOT-8-MD20	16,0	5,56	21,0°		■		■													■	

## INDUSTRY TARGETS

- **General Machining** Round insert copy mills are especially useful in high temp materials with increased nickel and chrome content. At lighter depths, their lower lead angle is especially useful in stainless steels and superalloys.
- **Aerospace** The aerospace industry is challenged with producing components that feature many different shapes and materials, from landing gears to structural components. Achieve versatility with this tool's full range of grades and chip grooves, which accommodate all such materials.
- **Mold & Die** Commonly used especially in larger mold and dies. Ideal in hard materials, the nature of a round insert allows for profiling non-linear shapes.
- **Power Generation** The power generation segment will utilize this tool in the manufacturing of fan blades made from tougher materials.
- **Oil & Gas** Complex, corrosion-resistant metals tend to cut insert life short through heavy notch wear. The lower lead angles achievable with round inserts allow chips to thin across a larger portion of the insert, reducing the concentration of wear in a particular area.

MATERIAL GROUPS
Steel P1-P11
Stainless Steel M1-M5
Cast Iron K1-K7
Non-ferrous N1-N11
Superalloys S1-S3
Hardened Steels H5-H21

IMPACT	BENEFITS	ADVANTAGES	FEATURES
Maximize your process security and consistency, even in demanding applications	Prevent the operation-compromising insert rotation common to round inserts	The notch ensure secure, accurate indexing	Notched insert pockets
Reduce machine downtime and cost per edge from indexing	Simplify indexing and reduce unused insert edges	Easily identify how far to index your inserts	Indexing flats on the insert

**Contact us:** **CHIHUAHUA. CHIH**  
gerencianoroeste@tannerherramientas.com  
Tel: (614) 414 2223

**GUAYMAS. SON**  
gerencianoroeste@tannerherramientas.com  
Tel: (622) 224 6081

**QUERÉTARO. QRO**  
gerenciacentro@tannerherramientas.com  
Tel: (442) 216 8862

Follow us on:  
in f t+ y

**EL PASO. TX**  
texas@tannerherramientas.com  
Tel: (915) 532 6165

**MONTERREY. NL**  
gerencianoroeste@tannerherramientas.com  
Tel: (81) 8312 1711

**TORREÓN. COAH**  
gerenciacoah@tannerherramientas.com  
Tel: (871) 169 3540